

Veneer Anchors

Adjusto-Tie™

Adjustable Veneer Anchor

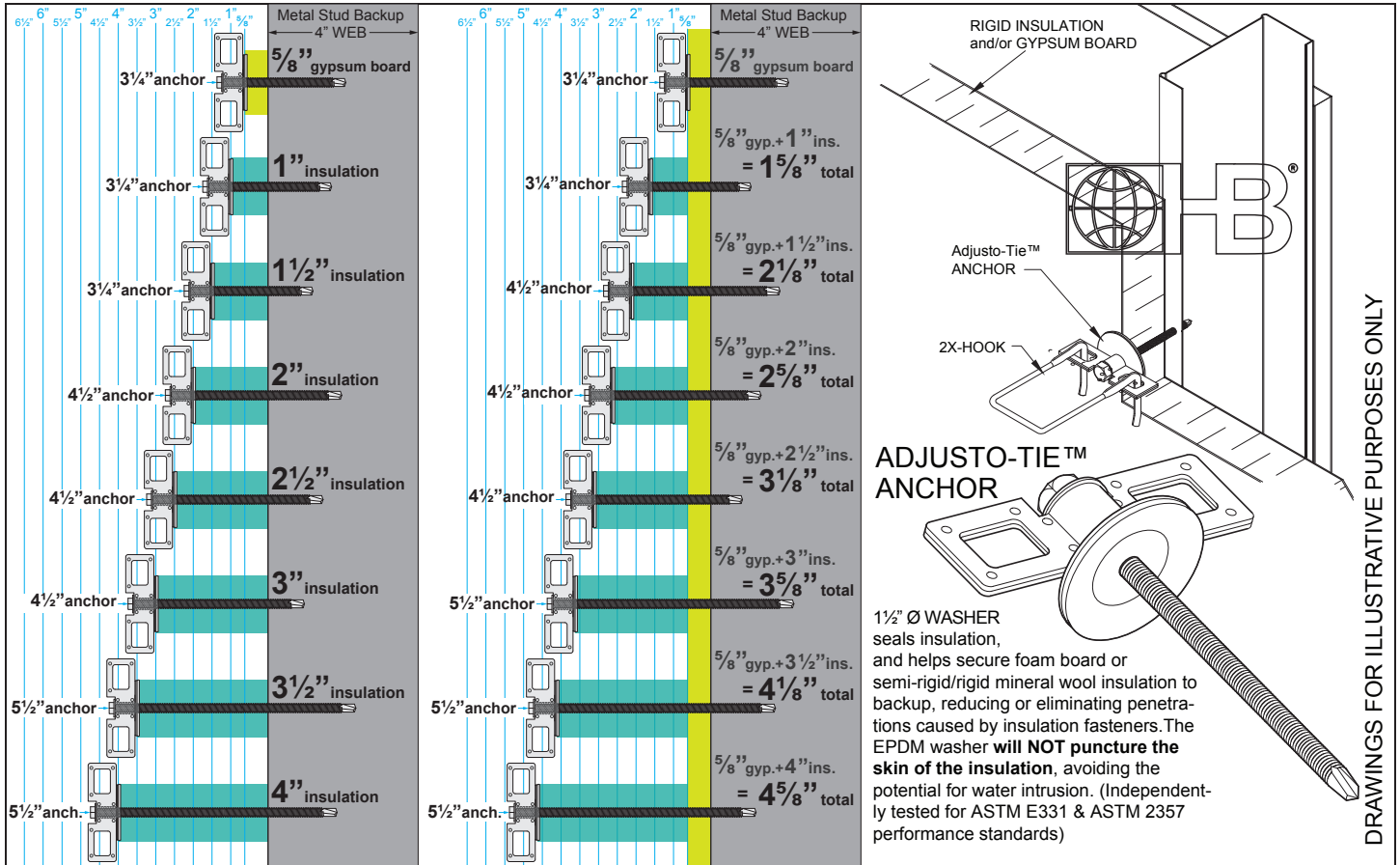

Adjusto-Tie™ an innovative single screw veneer tie for metal stud construction with a factory-installed EPDM washer to secure rigid insulation and/or gypsum sheathing to metal studs.

- Projecting "wings" accept a standard or seismic hook and spin to allow the installer to quickly orient pintles/hooks parallel to masonry joint.
- Fabricated with a 5/16" hex head, install with a standard hex socket.
- #12 screw, fully threaded shaft for additional adjustment, accommodates various insulation thicknesses by spinning the wing.

Screw (Carbon Steel): ASTM A510 (Carbon Steel)
ASTM C954 (1000-hour polymer coating)

Wire (Carbon Steel): Prefabricated from cold-drawn steel wire conforming to **ASTM A1064/A1064M**

Tensile Strength - 80,000 p.s.i. | Yield Point - 70,000 p.s.i. minimum Zinc Coating:

Hot-Dip Galvanized after fabrication: **ASTM A153/A153M-B (1.5 oz/ft²)**

Wire (Stainless Steel): ASTM A580/A580M - AISI Type 304 or Type 316

ADJUSTO-TIE w/2X HOOKS (WORKING LOAD*)

CAVITY	OFFSET			TEST
	0"	5/8"	1 1/4"	
6 1/2"	704#	325#	251#	TENSION
6 1/2"	470#	273#	250#	COMPRESSION

SCREW PULL-OUT (ULTIMATE LOAD) *Working Load Determined at .05" Deflection

STUD GA	18 GA	16 GA	14 GA	12 GA
	611#	743#	1096#	1394#

Tests were completed for 4 1/2" insulation with 2" air cavity.

Adjusto-Tie™ Finish: Polymer Coated

Adjusto-Tie™ Style (Select thickness of 5/8" wallboard and/or insulation):

3/4" anchor: 5/8" 1" 1 1/2" 1 5/8"

4 1/2" anchor: 2" 2 1/8" 2 1/2" 2 5/8" 3" 3 1/8"

5 1/2" anchor: 3 1/2" 3 5/8" 4" 4 1/8" 4 5/8"

Hook Finish:

Hot-Dip Galvanized | Stainless Steel Type 304 Type 316

3/16"Ø Compressed Leg Hook Length:

3" (300H-2X) 4" (400H-2X) 5" (500H-2X)

6" (600H-2X) 7" (700H-2X)

Compressed Leg Seismic Hook: - Length (Model), 3/16"Ø (5mm) wire

3" (300-S-2X) 4" (400-S-2X) 5" (500-S-2X)

Continuous Wire Finish: (Diameter 9 ga. 3/16"Ø)

Hot-Dip Galvanized | Stainless Steel Type 304 Type 316

NOTE: Some configurations are non-stock, contact your local sales manager for price, availability and lead times.

IMPORTANT: Since each construction project is unique, the appropriate selection and use of any product contained herein must be determined by competent architects, engineers and other appropriate professionals who are familiar with the specific requirements of the project in question.

This drawing and/or data sheet is the confidential and proprietary information of Hohmann & Barnard, Inc. and is not to be reproduced, copied or disclosed, in whole or in part, without the prior written consent of H&B.