

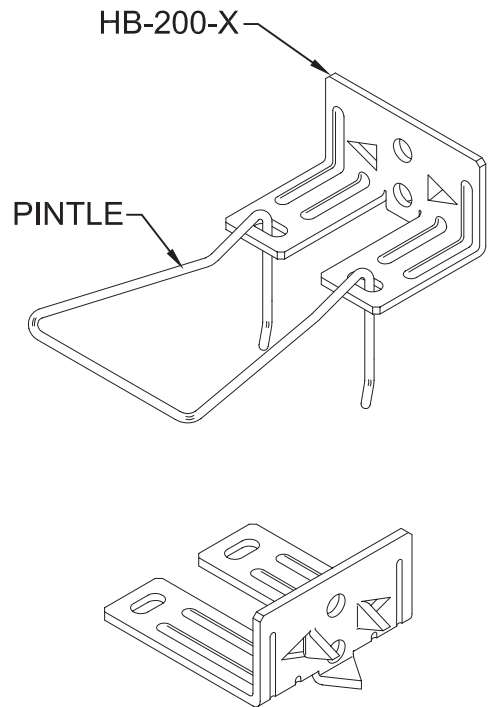

Veneer Anchors HB-200-X

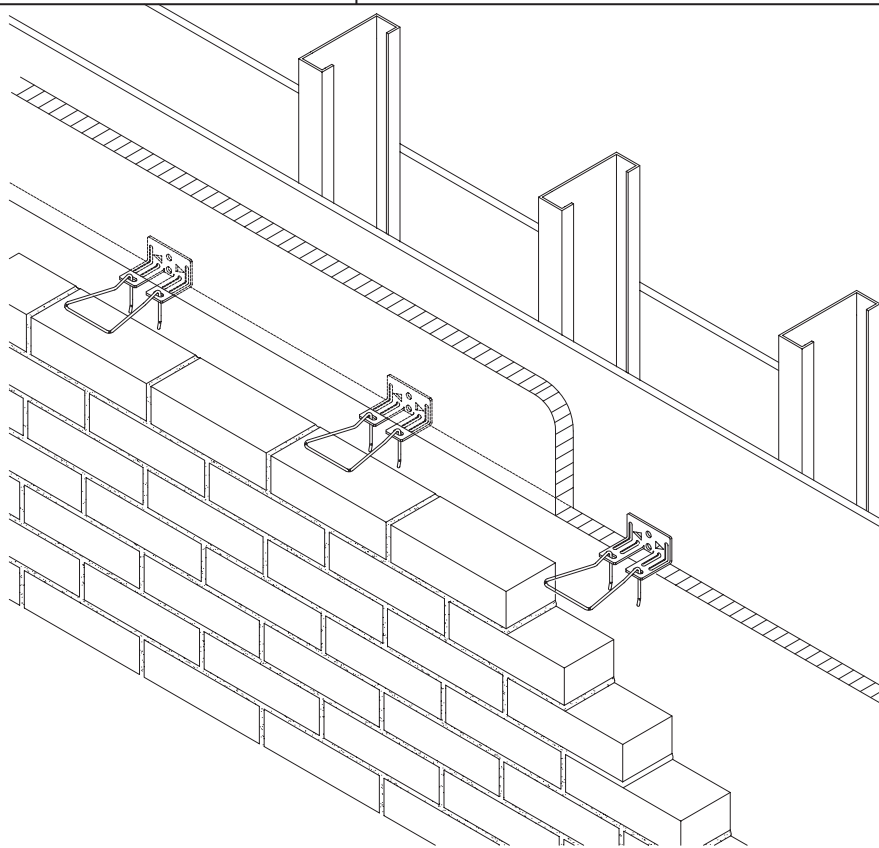

DRAWINGS FOR ILLUSTRATIVE PURPOSES ONLY

MATERIAL CONFORMANCE

Wire (Carbon Steel): Prefabricated from cold-drawn steel wire conforming to **ASTM A82/A82M**

Tensile Strength - 80,000 p.s.i. | Yield Point - 70,000 p.s.i. minimum
Zinc Coating:

Hot-Dip Galvanized after fabrication: **ASTM A153/A153M-B** (1.5 oz/ft²)
Note: Hohmann & Barnard will certify to a minimum of 2.0 oz/ft²

Wire (Stainless Steel): ASTM A580/A580M - AISI Type 304 (Type 316 available on special order)

Sheet Metal (Carbon Steel): ASTM A1008/A1008M

Zinc Coating:

Hot-Dip Galvanized: **ASTM A153/A153M Class B** (1.5 oz/ft²)
(sheet metal ties and anchors galvanized after fabrication)

Note: Hohmann & Barnard will certify to a minimum of 2.0 oz/ft²

Sheet Metal (Stainless Steel): ASTM A 666, ASTM A480, ASTM A240/A240M, and ASTM A167 - AISI Type 304 (Type 316 available on special order)

NOTE: H&B recommends Stainless Steel for maximum protection against corrosion.

Backplate Style (Equal to thickness insulation):

- | | |
|--|--|
| <input type="checkbox"/> HB-200-X (0") | <input type="checkbox"/> HB-200-X (3 1/2") |
| <input type="checkbox"/> HB-200-X (1") | <input type="checkbox"/> HB-200-X (4") |
| <input type="checkbox"/> HB-200-X (1 1/2") | <input type="checkbox"/> HB-200-X (4 1/2") |
| <input type="checkbox"/> HB-200-X (2") | <input type="checkbox"/> HB-200-X (5") |
| <input type="checkbox"/> HB-200-X (2 1/2") | <input type="checkbox"/> HB-200-X (5 1/2") |
| <input type="checkbox"/> HB-200-X (3") | <input type="checkbox"/> HB-200-X (6") |

Thickness:

- 14 Gauge
 12 Gauge

3/16"Ø Pintle Length:

- 3"
 4"
 4 3/4"
 5 1/4"
 Custom _____

Finish:

- Hot-Dip Galvanized
 Stainless Steel