

# Textroflash™ Liquid Air & Vapor Barrier

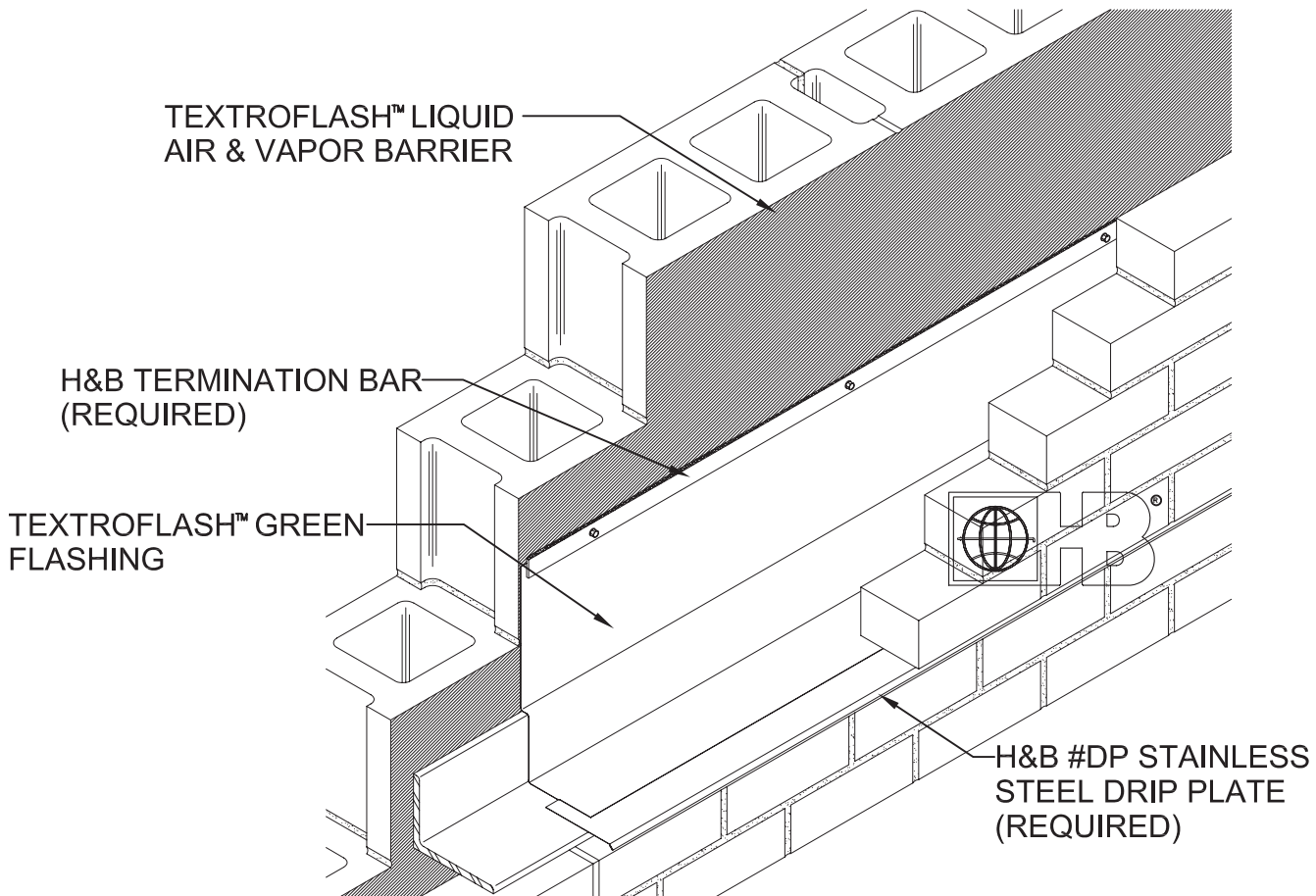

DRAWINGS FOR ILLUSTRATIVE PURPOSES ONLY

**AIR & VAPOR BARRIER**

Modified Emulsion Coating Spray & Brush-Grade Formula

**PRODUCT DESCRIPTION:**

- Latex modified asphalt emulsion with polymers and specialty additives to formulate a waterproof coating.
- Coverage rate of 25 square feet (45 mils) per gallon.
- VOC-Free, HAP's-Free & Asbestos-Free
- Above & below grade certified

**BASIC USES:** H&B's TEXTROFLASH™ LIQUID Modified Emulsion Coating is used as a protective coating for a variety of applications on asphalt, metal, masonry, and sheathing surfaces.

**APPLICATION:** H&B's TEXTROFLASH™ LIQUID Modified Emulsion Coating must be applied to a surface that is free from all foreign matter. This material should remain dry until it has cured. May be applied by brush, squeegee, or spray equipment.

- 5 Gallon Pail
- 55 Gallon Drum

**ASTM E 2178** (Air Permeance)  
Result: 0.00159 Perm m<sup>2</sup>

**ASTM E 96** (Water Vapor Permeance)  
Result: 0.08 Perm Average

**LIMITATIONS:** DO NOT ALLOW material to freeze. DO NOT THIN material. DO NOT heat product over 160°F as this can damage material.

**The following equipment is recommended for spraying:**

- |           |   |
|-----------|---|
| Pump      | GH 833  |
| PSI       | 1700-1850 PSI                                   |
| Spray Gun | BLUE TEXTURE                                    |
| Spray Tip | GHD 661   |
| Filters   | Remove any internal filters from pumping system |