

EPRA-MAX™ EPDM Thru-Wall Flashing

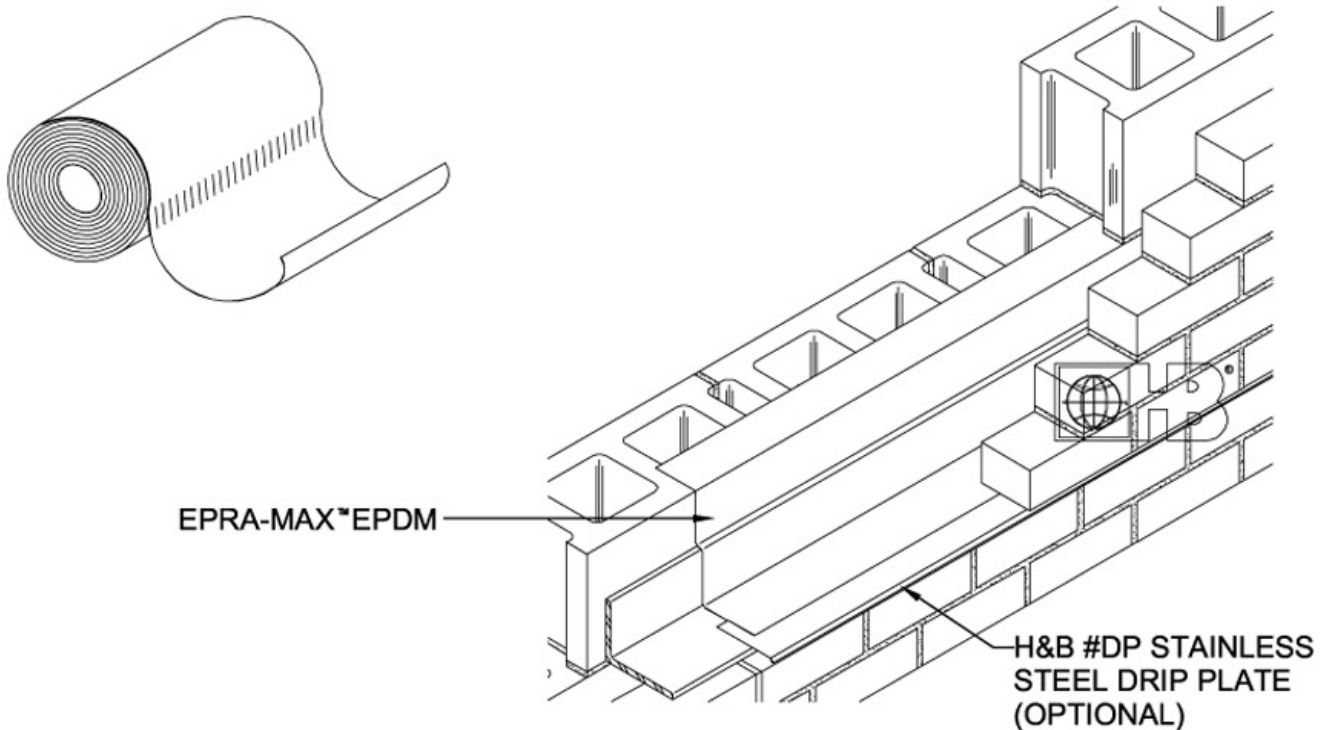

DRAWINGS FOR ILLUSTRATIVE PURPOSES ONLY

EPRA-MAX™ EPDM Thru-Wall Flashing

EPDM is a synthetic rubber that has been used extensively for decades in the roofing industry. Its durability under harsh, exposed roofing conditions renders it an ideal choice for use in more controlled applications, such as Thru-Wall Flashing.

- Superior tear and puncture resistance.
- Excellent elongation performance.
- Not susceptible to decomposition due to UV or ozone exposure.
- Will not "droll" in high temperatures
- High or low temperatures are not detrimental to EPDM performance.
- Stainless Steel Drip Plate #DP optional.

■ Rolls are 50ft. long

STANDARD WIDTHS:

- 12" 20"
- 16" 24"
- 18" 36"

CORNERS:

- Inside Outside

END DAMS

#DP - DRIP PLATE (Optional):

- 1 1/2" 3" OTHER _____

TERMINATION BAR (Optional)

- 1 1/2" Wide Butyl Tape (4Rolls/ctn)
- Spray Primer (12 Cans/ctn)
- Bonding Adhesive (5-Gallon Pail)

Note: Contact H&B technical dept. for complete storage & installation information.

EPRA-MAX™ TECHNICAL DATA TABLE

PROPERTY	TYPICAL VALUES	TEST METHOD
TENSILE STRENGTH	1305 PSI 9 Mpa	ASTM D-412, Die C
ELONGATION	300%	ASTM D-412, Die C
TEAR RESISTANCE	150 lbf/in 26.3 kN/m, 26.4	ASTM D-624, Die C
OZONE RESISTANCE: 166 HRS./100 PPHM @ 104°F WITH 50% EXTENSION HEAT AGING: 29 DAYS @ 240°F	No Cracks	ASTM D-1140 ASTM D-573
TENSILE STRENGTH	1205 PSI 8.3 Mpa	ASTM D-412
ELONGATION	200%	ASTM D-412
BRITTLENESS POINT	-49°F -45°C	ASTM D-2137
WATER ABSORPTION, CHANGE IN WEIGHT AFTER IMMERSION IN WATER 166 HRS. @ 158°F	+8, -2%	ASTM D-471
WATER VAPOR PERMEABILITY	2.0 Perm-Mils	ASTM E-96